

# 15 01 Broadway Suite 22

FAIRLAWN, NJ

NEWMARK  
ASSOCIATES | CRE  
CERTIFIED WBE

## For Sale

### MUST BE SOLD

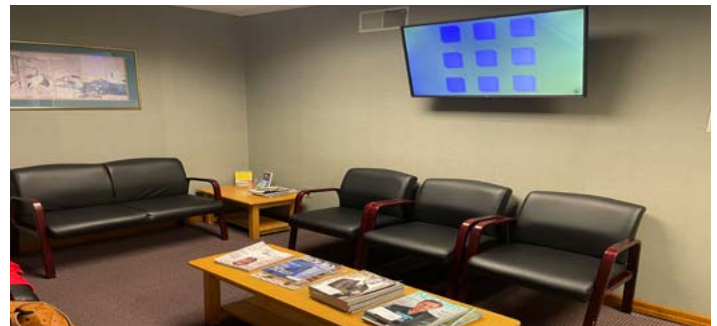

## Condo Features

- Approximately 1500SF
- 3 Exam Rooms with SINKS
- Spacious Waiting Room
- Administration/Reception Area
- Lead Lined Room
- Staff Break Room
- 2 MD Offices
- IT Room
- Private MD Office
- Great Window Line
- Full Bathroom

## Property/Building Features

- Professional/Medical Condominium of 45000SF
- Monument Signage on Broadway (Route 4)
- Patient and Freight Elevator
- On Site Parking - VERY GENEROUS
- ADA Access from Parking Lot/Automatic Doors
- 24/7 Surveillance of Parking Lot and Building
- Well Funded Condo Association
- Accessible by Bus Lines 164, 171, 170 and to Train Lines MCL & PJF
- Minutes from GSP and Route 80
- Close to St. Joseph's, Paterson, Valley and Hackensack Hospitals
- Walking Distance to Restaurants and Shops

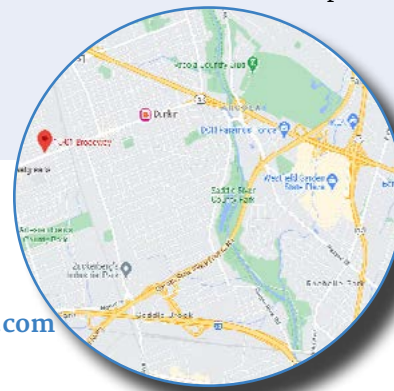

## Contact Our Exclusive Agents

**Judith Feldman**

[jfeldman@newmarkrealestate.com](mailto:jfeldman@newmarkrealestate.com)

Mobile: 973.713.7918

Office: 973.884.4444 ext. 28

**Therese O'Brian**

[tobrian@newmarkrealestate.com](mailto:tobrian@newmarkrealestate.com)

Mobile: 973.945.4136

Office: 973.884.4444 ext. 37



YEARS STRONG

2021 Newmark Associates, CRE, LLC. Information obtained from sources deemed to be reliable. However, no guarantee, warrant or representation is made as to accuracy of the information presented which is submitted subject to errors, omission, change of price, rental or other conditions, prior sale lease, financing or withdrawal without notice. Projections, opinions, assumptions or estimates are provided for example only, and may not represent current or future performance. Interested parties should consult their tax and legal advisors and conduct a thorough investigation of the property and any prospective transaction.

7 E. Frederick Place Suite 500 Cedar Knolls New Jersey 07927 | 973.884.4444 | [NewmarkRealEstate.com](http://NewmarkRealEstate.com)

# 15 01 Broadway Suite 22

FAIRLAWN, NJ

NEWMARK  
ASSOCIATES | CRE  
CERTIFIEDWBE

For Sale

## Floor Plan

15 01 Broadway, Fair Lawn, NJ  
Unit 22

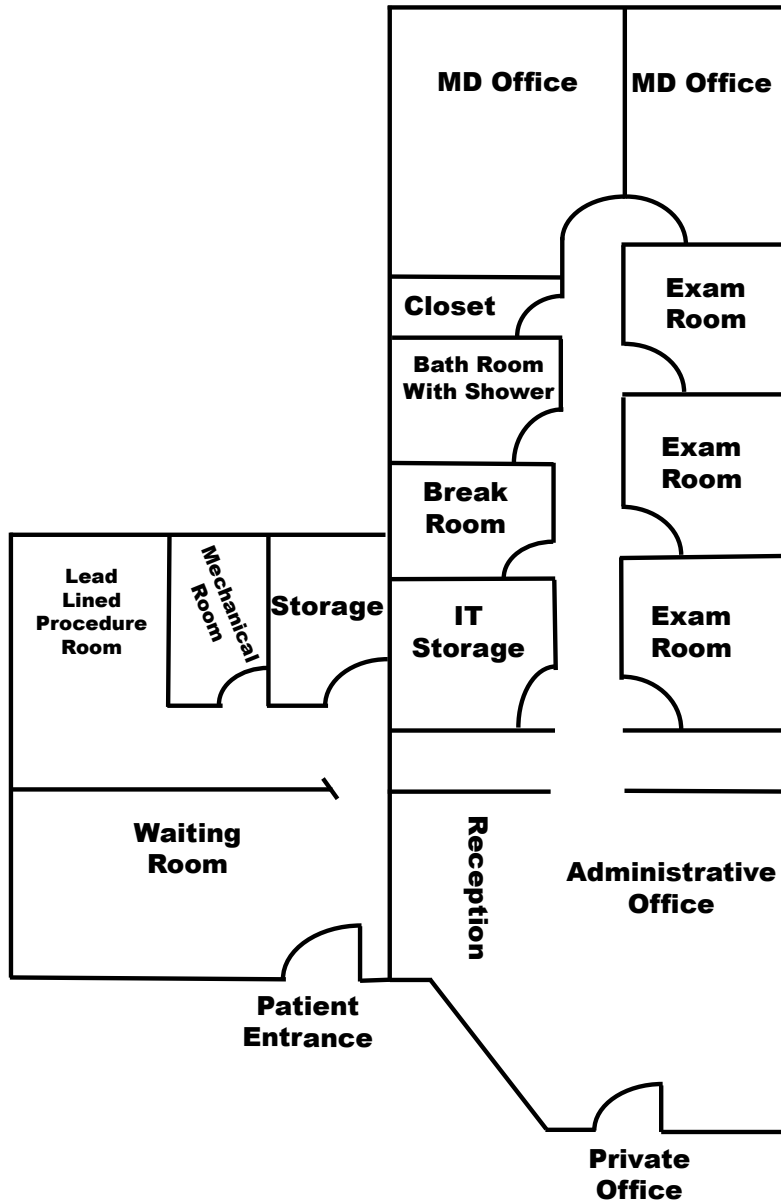

2021 Newmark Associates, CRE, LLC. Information obtained from sources deemed to be reliable. However, no guarantee, warrant or representation is made as to accuracy of the information presented which is submitted subject to errors, omission, change of price, rental or other conditions, prior sale lease, financing or withdrawal without notice. Projections, opinions, assumptions or estimates are provided for example only, and may not represent current or future performance. Interested parties should consult their tax and legal advisors and conduct a thorough investigation of the property and any prospective transaction.