



9424 Cassia Road

Adelanto, California 92301

Sale Highlights

- Asking: \$2,750,000 - \$186 PSF
- Bldg Size: ±14,800 SF
- Lot Size: ±2 Acres
- APN: 3129-261-65
- Zoning: MI - Manufacturing Industrial

Property Features

- One of the highest quality buildings within Adelanto Industrial Park
- Located on Cassia Road, East of Beaver Road, West of Koala Road
- Additional pad ready for a 6,000 SF building
- Includes; 600 Amps, 4 roll up doors, 2 iron entry gates, sprinklers
- Application filed for an additional 2,000 amps

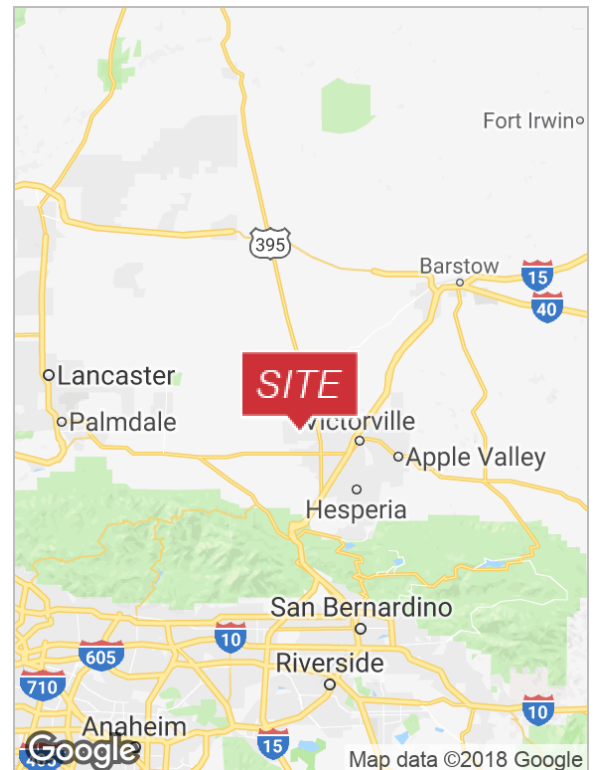

For more information

Mehdi Mostaedi, ALC

O: 760.780.4210

mmostaedi@naicapital.com | CalDRE #01392527

For Sale

9424 Cassia Road



Mehdi Mostaedi, ALC
760.780.4210
mmostaedi@naicapital.com
CalDRE #01392527

NAICapital
COMMERCIAL REAL ESTATE SERVICES, WORLDWIDE

For Sale

9424 Cassia Road



Mehdi Mostaedi, ALC
760.780.4210
mmostaedi@naicapital.com
CalDRE #01392527

For Sale

9424 Cassia Road



Mehdi Mostaedi, ALC
760.780.4210
mmostaedi@naicapital.com
CalDRE #01392527

For Sale

9424 Cassia Road

High Paddy Assessment
9424 CASSIA ROAD u.c.
APN 3129-261-65
SCALE: 1/16" = 1'

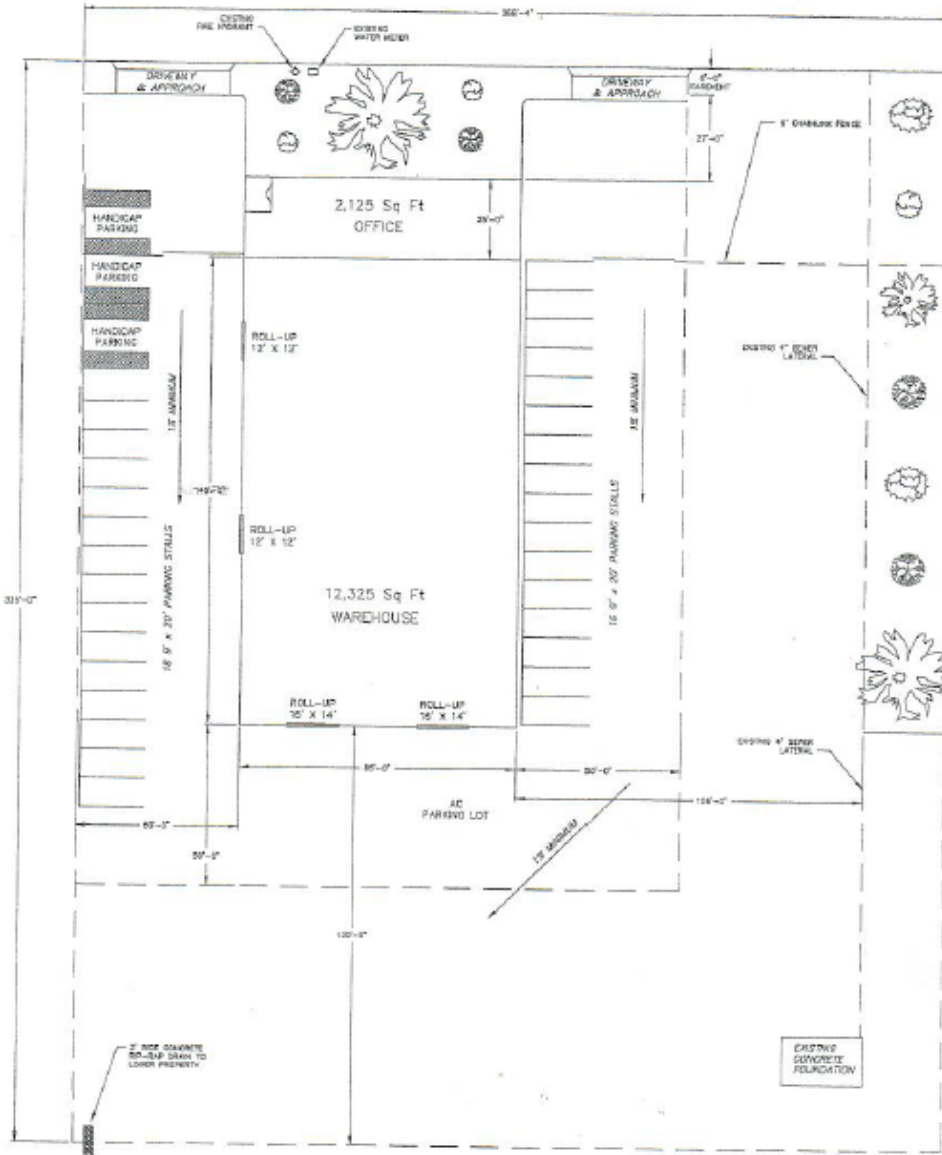

Mehdi Mostaedi, ALC
760.780.4210
mmostaedi@naicapital.com
CalDRE #01392527