

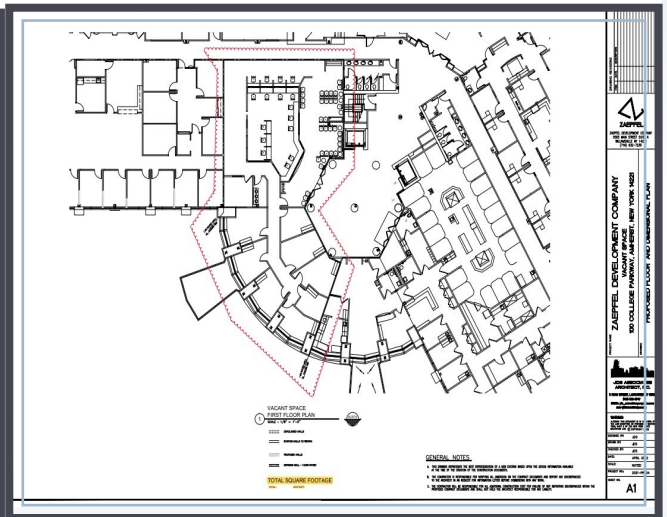

DEVELOPMENT COMPANY

LEASING



**100 COLLEGE PARKWAY,
SUITE 240, AMHERST, NEW YORK**

OFFICE

4,325 SQUARE FEET

College Park is a 50 acre Class "A" premier office development, excellent proximity to major travel routes and transportation centers, and abundant parking.

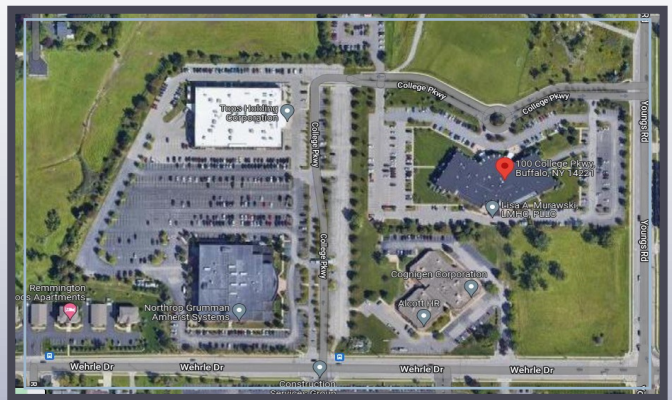

716-632-7230

www.ZAEPFEL.COM

ZAEPFEL DEVELOPMENT COMPANY, 5505 Main Street, Suite A, Williamsville, NY 14221

The information contained herein is deemed reliable but not guaranteed