

65 Westchester Avenue | Pound Ridge, NY

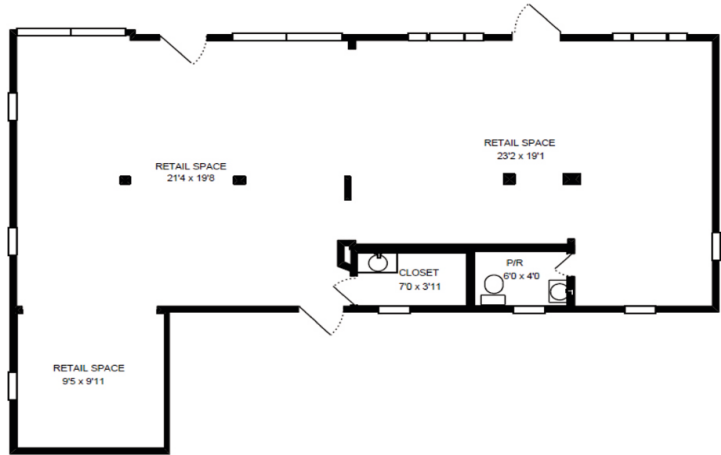

PRIME COMMERCIAL CORNER LOCATION - 977 SF \$2895/MO NNN

FOR LEASE-Scotts Corners most desirable corner lot location!! Free-standing building filled with tons of charm and character which fits the setting of the quaint and affluent town of Pound Ridge, NY. Cross roads to New Canaan and Stamford, CT, Bedford, South Salem and neighboring towns. Highly visible on a corner lot, the busiest intersection in town, walking distance to Market, Post Office, KeyBank! A destination to visitors from NYC that want to enjoy the small town country feel with fantastic restaurants, shops and services right here in heart of Scotts Corners! Includes Rear and Front patios with ample parking! Perfect for Retail, Art Gallery, Professional Offices, Coffee Shop, ...and so much more! Lease is NNN.

Lease Price: \$2,895.00/Mo



Elaine A Voss - AREP- CIREC - CLHMS
Real Estate Salesperson

914.234.3647
914.774.5459
elaine.voss@cbmoves.com



COLDWELL BANKER
REALTY

elainevoss.cbintouch.com



This information was supplied by Seller and/or other sources. Broker believes this information to be correct but has not verified this information and assumes no legal responsibility for its accuracy. Buyers should investigate these issues to their own satisfaction. If your property is currently listed for sale, this is not intended as a solicitation. If your property is listed with a real estate broker, please disregard. It is not our intention to solicit the offerings of other real estate brokers. We are happy to work with them and cooperate fully. Coldwell Banker and the Coldwell Banker Logo are registered service marks of Coldwell Banker Real Estate LLC. Coldwell Banker Residential Brokerage is owned by a subsidiary of NRT LLC. If you have a brokerage relationship with another agency, this is not intended as a solicitation.