

FOR LEASE
SHARE

MEDICAL OFFICES CONDO



MIDTOWN PLAZA

**201 SW 84th Ave,
Plantation, FL 33324**



- Class "A" Medical
- State of the art medical office space
- Ample parking
- Close to 595 and Broward Mall & many restaurants
- Down the street from Westside Regional Medical Center



FOR LEASE 2,061 ±SQFT

\$3,800/Month
+ Sales Tax

SHARE

PRICE NEGOTIABLE



JOE PELAYO/CCIM, SIOR
trec@joepelayo.com
954.224.8773

CALL US!
TREC
Total Real Estate Consultants Inc.
www.trecfl.com
954.341.3294

AMY IANNELLO/PA-C
amypac@yahoo.com
954.483.4869



GEORGE PELAYO/REALTOR®
georgetrec@joepelayo.com
954.557.3300



FOR LEASE
FOR SHARE

FLOOR PLAN: Unit for **LEASE** Units for **SHARE**

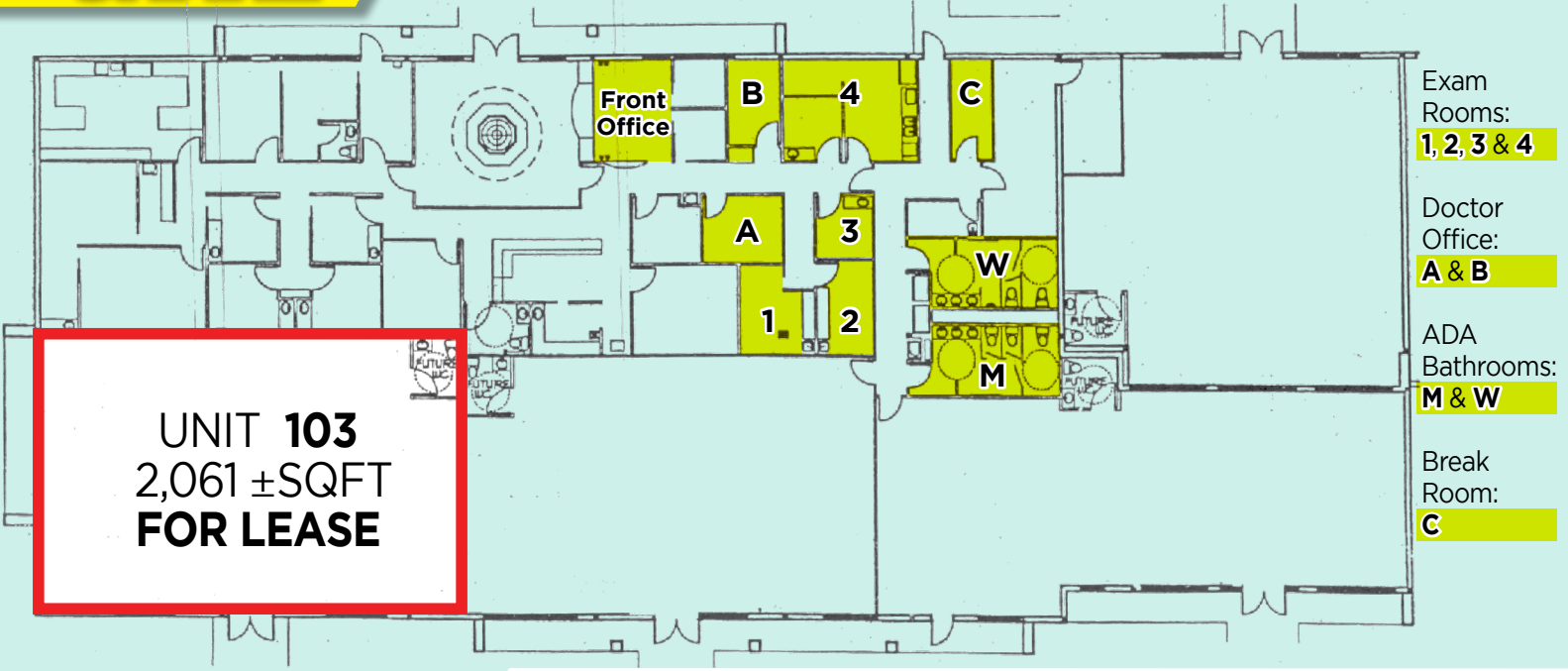

201 SW 84th Ave, Plantation, FL 33324



JOE PELAYO/CCIM, SIOR
trec@joepelayo.com
954.224.8773

CALL US!
TREC
Total Real Estate Consultants Inc.
www.trecfl.com
954.341.3294

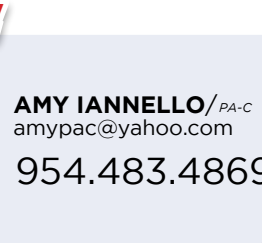

AMY IANNELLO/PA-C
amypac@yahoo.com
954.483.4869



GEORGE PELAYO/REALTOR®
georgetrec@joepelayo.com
954.557.3300

Note: This offering subject to errors, omissions, prior sales or withdrawal without notice.