

2 Ridgedale Avenue

CEDAR KNOLLS, NJ

PROFESSIONAL OFFICE SUITE FOR LEASE



Available Space

- Suite 206: Approx. +/- 1435 SF
- Large Bullpen w/Open Kitchen
- Two (2) Private Windowed Offices

Property/Building Features

- Building Size: Approx. 70,400 SF
- 3 Story Office Building
- Office Park Setting
- On-Site Banking
- Abundant Parking
- Proximity to ShopRite of Morristown, Wegmans & Marriott Hotel
- Near All Major Highways; Located at the Rt 10/287/80 Interchange



Rental RATE \$16.50 psf Plus Tenant Electric

Contact Our Exclusive Agents

Helene Elbaum

helebam@newmarkrealestate.com

Mobile: 201.320.3430

Office: 973.884.4444 ext. 26

Courtney Brooke Rosenkrantz

crosenkrantz@newmarkrealestate.com

Mobile: 908.418.0984

Office: 973.884.4444 ext. 33



YEARS STRONG

2020 Newmark Associates, CRE, LLC. Information obtained from sources deemed to be reliable. However, no guarantee, warrant or representation is made as to accuracy of the information presented which is submitted subject to errors, omission, change of price, rental or other conditions, prior sale lease, financing or withdrawal without notice. Projections, opinions, assumptions or estimates are provided for example only, and may not represent current or future performance. Interested parties should consult their tax and legal advisors and conduct a thorough investigation of the property and any prospective transaction.

2 Ridgedale Avenue

CEDAR KNOLLS, NJ

Floor Plan Second Floor Suite 206

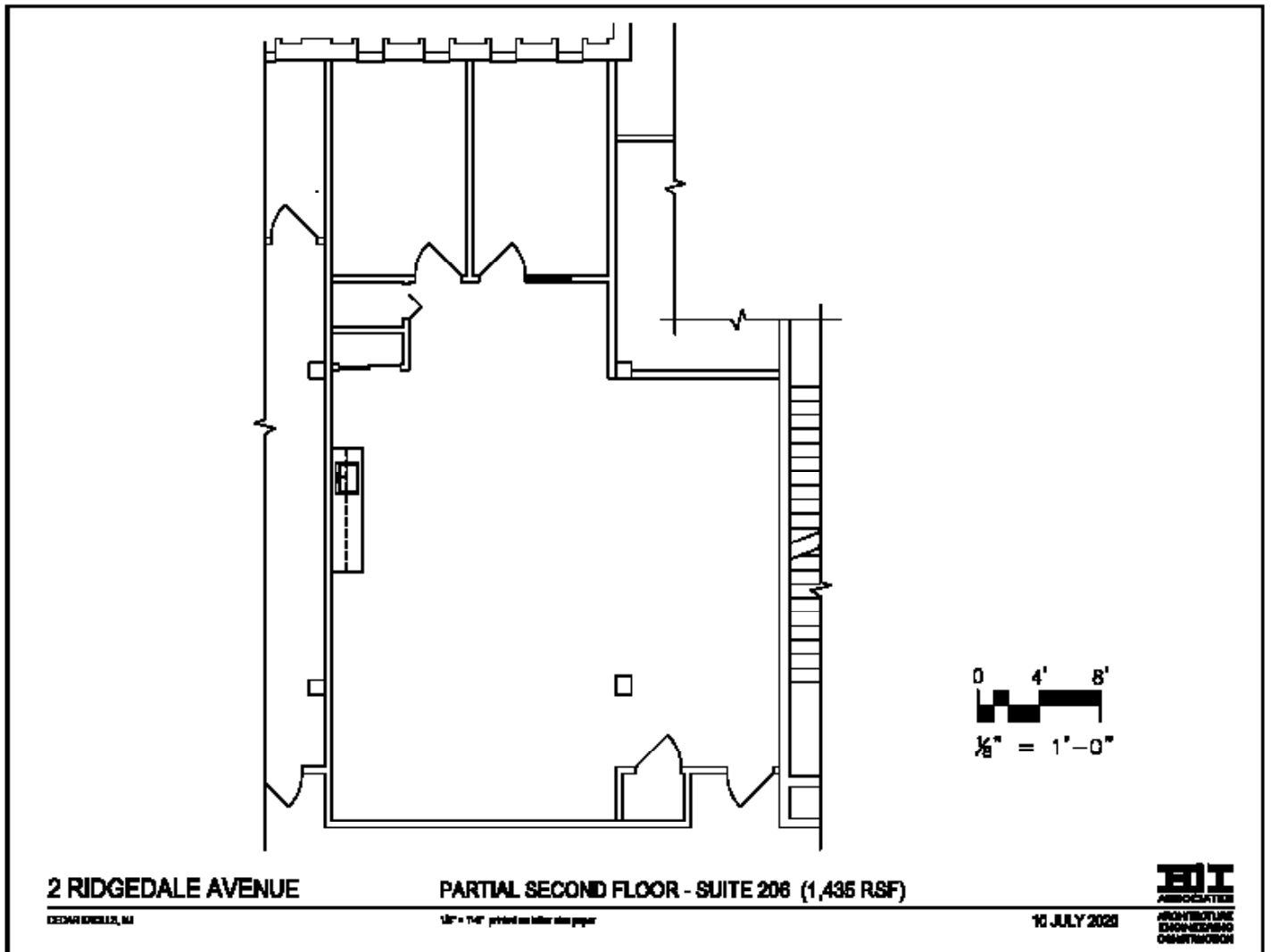

YEARS STRONG

2020 Newmark Associates, CRE, LLC. Information obtained from sources deemed to be reliable. However, no guarantee, warrant or representation is made as to accuracy of the information presented which is submitted subject to errors, omission, change of price, rental or other conditions, prior sale lease, financing or withdrawal without notice. Projections, opinions, assumptions or estimates are provided for example only, and may not represent current or future performance. Interested parties should consult their tax and legal advisors and conduct a thorough investigation of the property and any prospective transaction.