



# cRc Nationwide

6936 SOUTH PROMENADE DRIVE  
COTTONWOOD HEIGHTS, UTAH 84121



- SUITE 101: 869 RSF  
Available December 15, 2018
- SUITE 102: 973 RSF  
Available December 15, 2018
- SUITE 101 & 102: 1,842 RSF
- Parking Ratio: 5.50/1,000 SF
- Large Windows - Great Natural Light
- Monument Signage Available
- Desirable East Side Location
- Close To Cottonwood Canyons
- 9,486 Total RSF
- Easy Access to I-215

## Demographics

	1 Mile	3 Mile	5 Mile
Population	15,225	97,411	240,876
Households	5,556	36,217	89,127
Avg. Household Income	\$78,379	\$78,461	\$68,707

## Traffic Counts

Fort Union Blvd: 27,995 Annual Average Daily Traffic  
 2300 South: 11,835 Annual Average Daily Traffic

**LEASE RATE:**  
**\$10.50/SF YEAR NNN**



# cRc Nationwide

6936 SOUTH PROMENADE DRIVE  
COTTONWOOD HEIGHTS, UTAH 84121

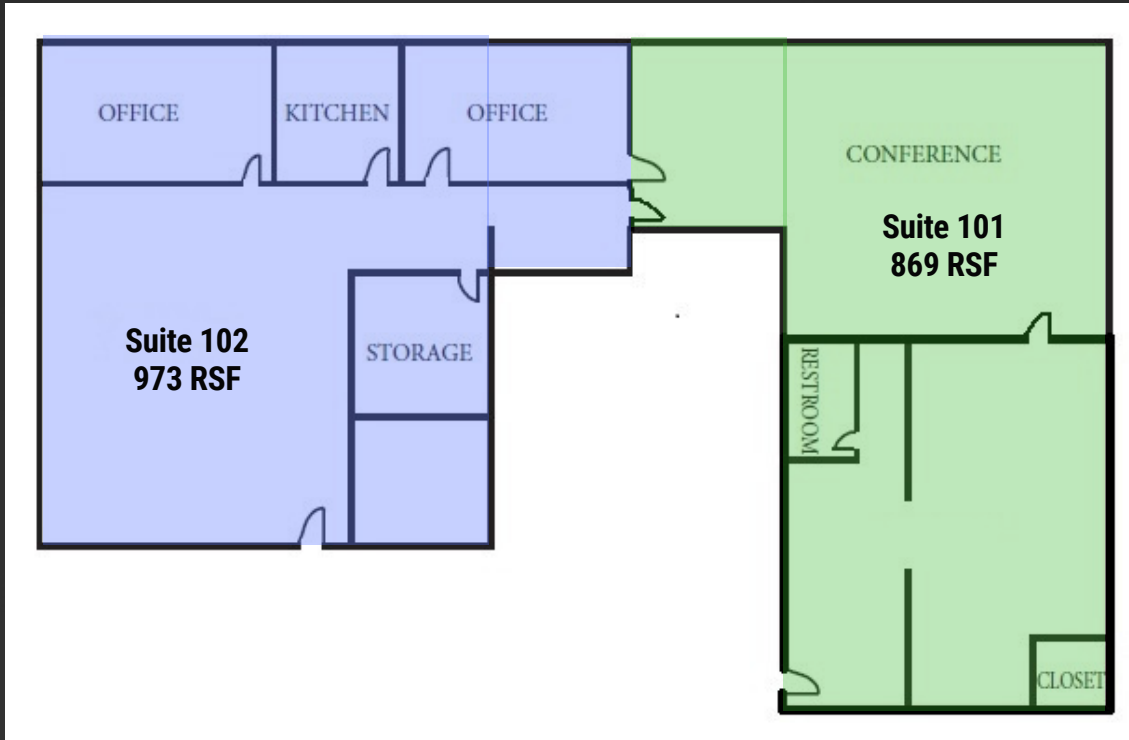

**COSTAR  
POWER BROKER AWARD  
TOP FIRM**  
2010, 2011, 2012, 2013,  
2014, 2015, 2016, 2017

## 801.617.1700

KELLEN KONCAR  
KELLEN.KONCAR@CRCNATIONWIDE.COM

DANEILE.SNELLING  
DANEILE.SNELLING@CRCNATIONWIDE.COM

DANEILE.SNELLING