



CRC NATIONWIDE

5718 W. DANNON WAY, WEST JORDAN 84081

OFFICE/WAREHOUSE WITH FENCED YARD



PROPERTY INFORMATION

- 8,029 SF OFFICE/WAREHOUSE
- (2) 12' X 14' OVERHEAD LEADING DOORS
- CLEARANCE HEIGHT: 12' - 17'
- 0.50 ACRES AVAILABLE FOR LEASE
- 3 PHASE POWER/400 AMP/240 VOLT
- ZONING: M-1
- SITE SIZE: 2.50 ACRES
- FENCED LOT
- EASY ACCESS TO NEW BINGHAM HWY AND MOUNTAIN VIEW CORRIDOR

LEASE RATE

\$0.55/SF MONTH NNN

DEMOGRAPHICS

	1 MILE	3 MILE	5 MILE
TOTAL POPULATION	767	17,266	28,835
TOTAL HOUSEHOLDS	252	5,830	9,478
AVG. HOUSEHOLD INCOME	\$82,436	\$64,605	\$67,418

TRAFFIC COUNTS

NEW BINGHAM HWY: 8,510 ANNUAL AVERAGE DAILY TRAFFIC

5600 WEST: 4,409 ANNUAL AVERAGE DAILY TRAFFIC

801.617.1700

DEREK KLOPFER

DEREK.KLOPFER@CRCNATIONWIDE.COM



COSTAR
POWER BROKER AWARD
TOP FIRM IN SALES & LEASING
2010, 2011, 2012, 2013, 2014, 2015, 2016



CRC NATIONWIDE

5718 W. DANNON WAY, WEST JORDAN 84081

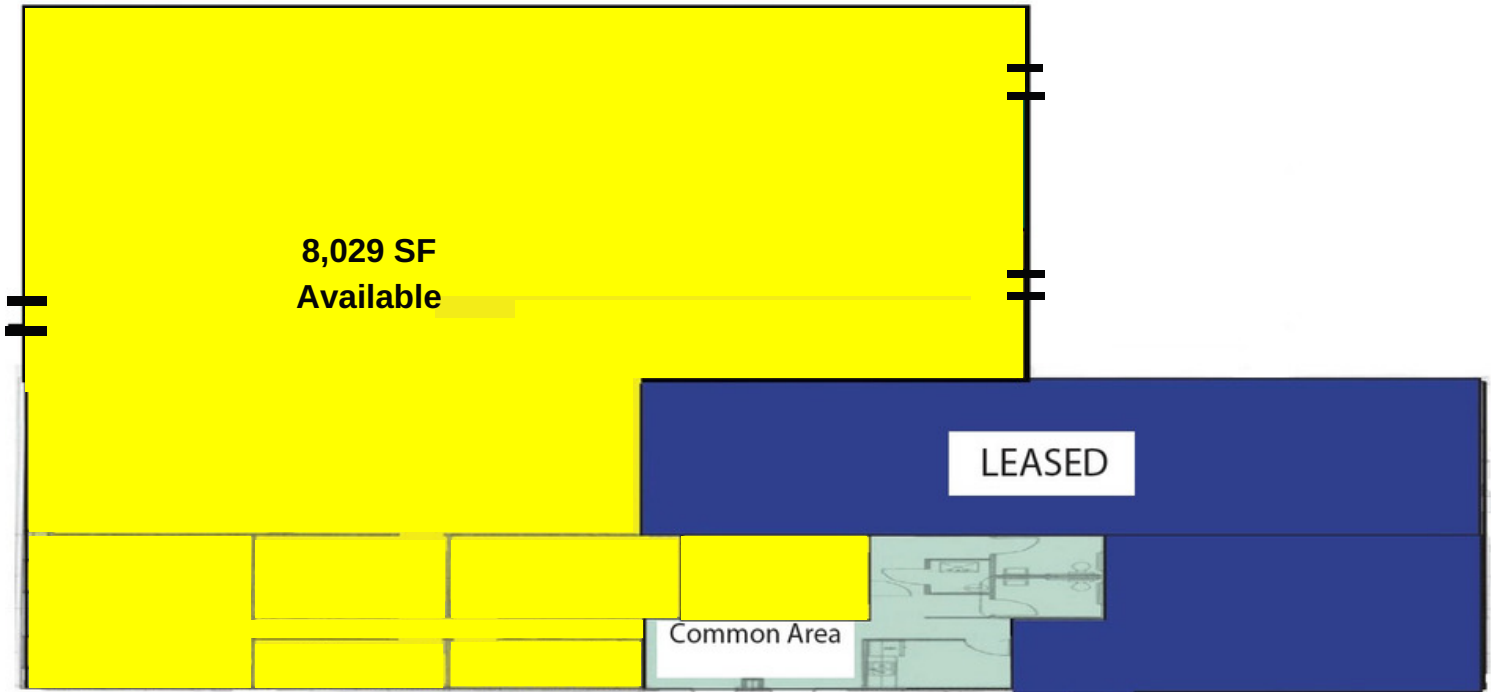

801.617.1700

DEREK KLOPFER

DEREK.KLOPFER@CRCNATIONWIDE.COM

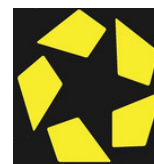

COSTAR
 POWER BROKER AWARD
 TOP FIRM IN SALES & LEASING
 2010, 2011, 2012, 2013, 2014, 2015, 2016