



c R c Nationwide

COMMERCIAL REAL ESTATE CONSULTANTS

3500 S. MAIN STREET, SOUTH SALT LAKE, UTAH 84115

RATE REDUCTION!!



- Suite 106: 1,156 RSF
- Main Level Suite with Great Natural Light
- Includes Utilities
- Great Floor Plan with Kitchenette
- Fiber Available
- Ample Parking
- Available Storage Space
- Monument Signage
- Great Visibility on Main Street
- Central Location
- Shops, Restaurants, Amenities Nearby
- Immediate I-15 Access
- Co Tenants: Attorney Paul J. Barton, Kinnect Inc., Goble Sampson, ESI Engineering

Demographics

	1 Mile	3 Mile	5 Mile
Population	14,178	137,229	381,225
Households	5,538	55,307	144,623
Avg. Household Income	\$38,087	\$46,348	\$54,271

LEASE RATE REDUCED!!

~~\$13.50/SF YEAR~~

\$12.00/SF YEAR

FULL SERVICE

Traffic Counts

Main Street: 9,105 Annual Average Daily Traffic

3300 South: 36,540 Annual Average Daily Traffic

801.617.1700

KELLEN KONCAR

KELLEN.KONCAR@CRCNATIONWIDE.COM

DANEILE SNELLING

DANEILE.SNELLING@CRCNATIONWIDE.COM



c R c N a t i o n w i d e

3500 S. MAIN STREET, SOUTH SALT LAKE, UTAH 84115

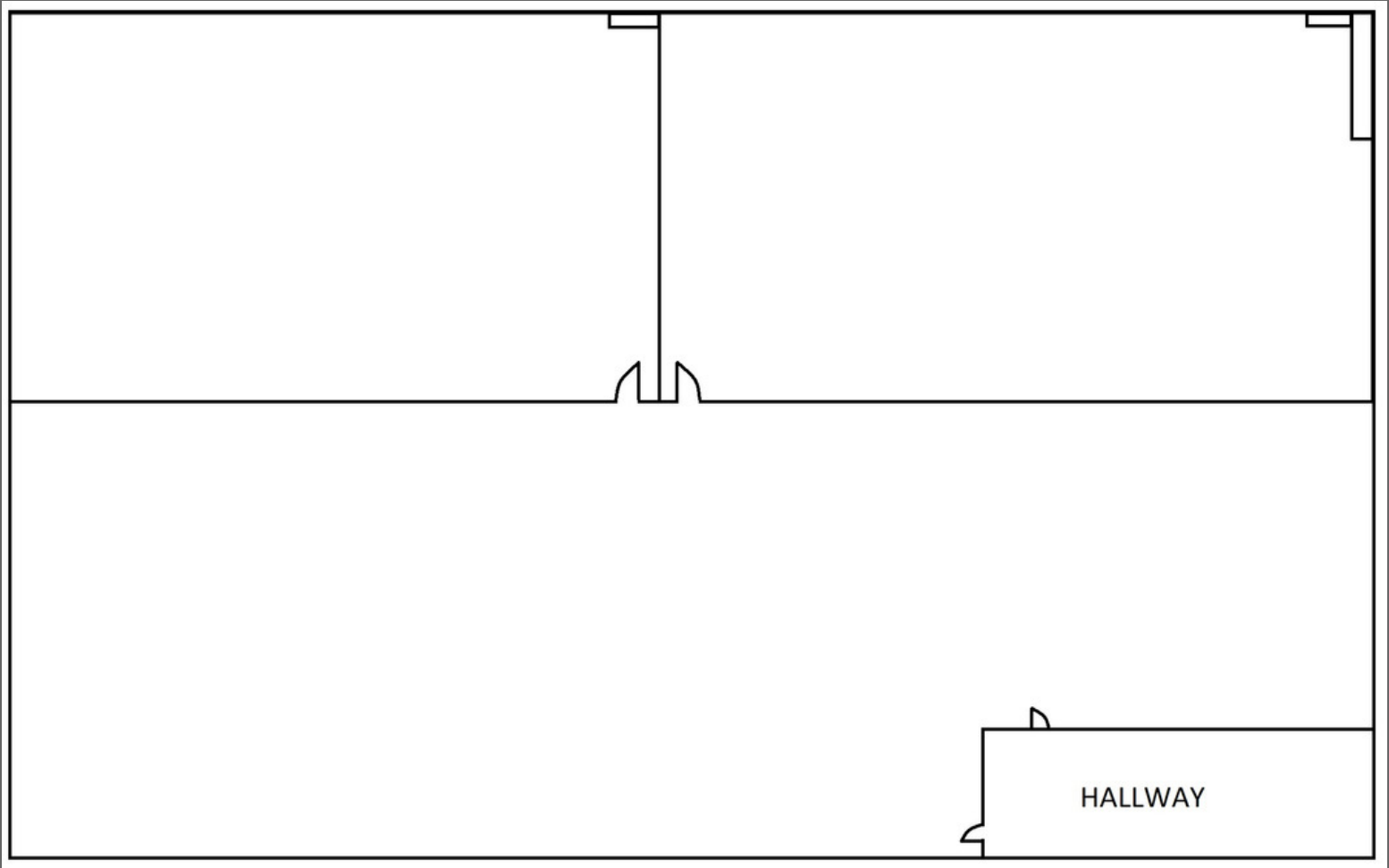

801.617.1700

KELLEN KONCAR

KELLEN.KONCAR@CRCNATIONWIDE.COM

DANEILE SNELLING

DANEILE.SNELLING@CRCNATIONWIDE.COM



c R c N a t i o n w i d e

3500 S. MAIN STREET, SOUTH SALT LAKE, UTAH 84115



801.617.1700

KELLEN KONCAR

KELLEN.KONCAR@CRCNATIONWIDE.COM

DANEILE SNELLING

DANEILE.SNELLING@CRCNATIONWIDE.COM