



cRc Nationwide

COMMERCIAL REAL ESTATE CONSULTANTS



1743 WEST 6200 SOUTH, SALT LAKE CITY, UTAH 84129

- 1,100 SF Available
- Newly Renovated Office
- Corner of Redwood Road
- High Traffic Counts
- Parking: 3/1,000 SF
- Easy Access to I-215

LEASE RATE: \$875.00/MONTH NNN

Demographics

	1 Mile	3 Mile	5 Mile
Population	15,202	139,235	412,701
Households	5,098	45,958	137,323
Avg. Household Income	\$73,090	\$60,558	\$58,054

Traffic Counts

Redwood Road: 37,843 Annual Average Daily Traffic
 6200 South: 37,238 Annual Average Daily Traffic

Contact: 801.617.1700

GREG MCDONALD
 GREG.MCDONALD@CRCNATIONWIDE.COM

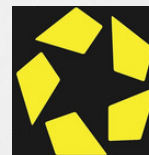

**COSTAR
 POWER BROKER AWARD**
 TOP FIRM IN SALES & LEASING
 2010, 2011, 2012, 2013, 2014, 2015, 2016



cRc Nationwide

COMMERCIAL REAL ESTATE CONSULTANTS

1743 WEST 6200 SOUTH, SALT LAKE CITY, UTAH 84129

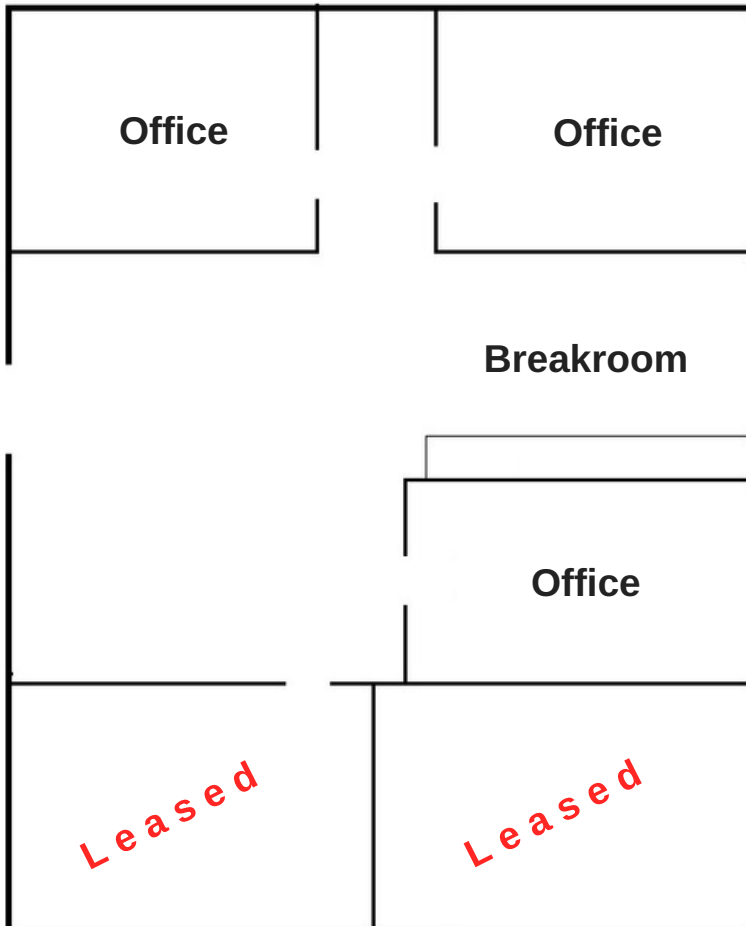

801.617.1700

GREG MCDONALD

GREG.MCDONALD@CRCNATIONWIDE.COM