



# cRc Nationwide

COMMERCIAL REAL ESTATE CONSULTANTS



**FOR LEASE**

## WAREHOUSE WITH FENCED YARD

999 WEST 1500 SOUTH, WOODS CROSS 84087

- SUITE 700: 14,500 SF
  - 10' x 10' Office Space
  - (1) 12' x 12' Ramp Access Door
  - (1) 8' x 9' Dock High
  - (2) Restrooms (ADA Compliant)
- Clearance Height 14' - 30'
- Heavy Power Available
- Rail Spur Available
- CAMS: \$0.08
- Easy Access to I-15, Hwy 89, Legacy Parkway and I-215

**LEASE RATE REDUCED!!**

~~**\$0.35/SF/MONTH NNN**~~

**\$0.33/SF/MONTH NNN**

**801.617.1700**

CORY MARTIN

CORY.MARTIN@CRCNATIONWIDE.COM

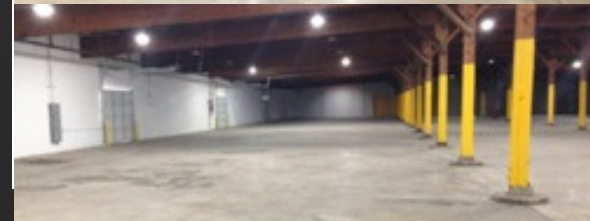



# cRc Nationwide

COMMERCIAL REAL ESTATE CONSULTANTS



999 WEST 1500 SOUTH, WOODS CROSS, UTAH 84087

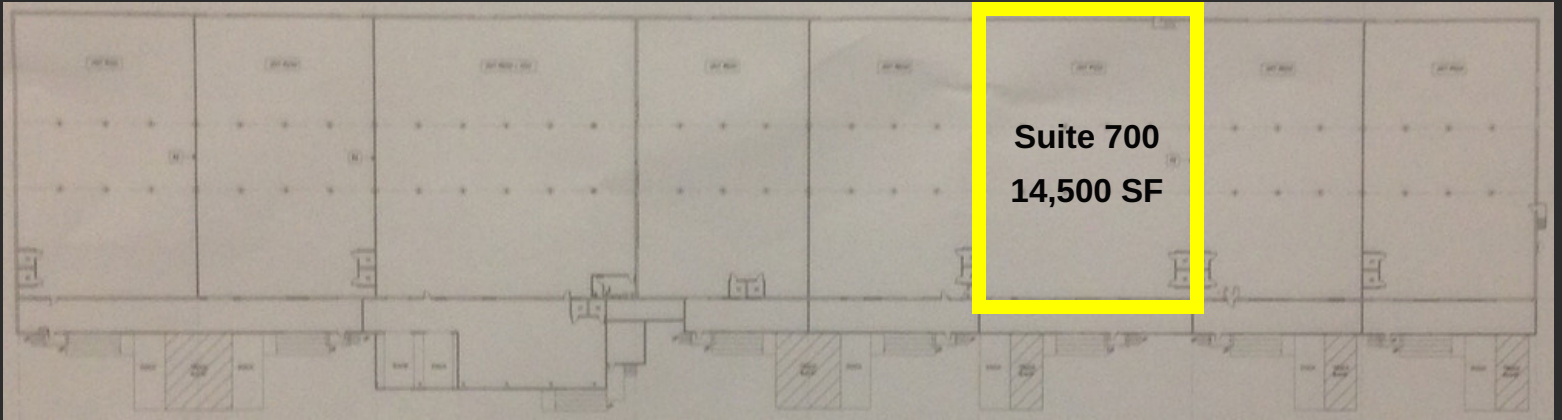

Suite 700  
14,500 SF



801.617.1700

CORY MARTIN  
CORY.MARTIN@CRCNATIONWIDE.COM



COSTAR  
POWER BROKER AWARD  
TOP FIRM IN SALES & LEASING  
2010, 2011, 2012, 2013, 2014, 2015, 2016