

TENANT SPACE	OCCUPANCY TYPE	# OF OCCUPANTS	EXITS REQUIRED	EXITS PROVIDED	COMMON PATH OF TRAVEL ALLOWED*	MAX. TRAVEL DISTANCE ALLOWED*	MAX. DEAD END ALLOWED*	WATER CLOSETS REQUIRED	WATER CLOSETS PROVIDED	PARKING SPACES REQUIRED***
A	BUSINESS (1/100 SF)	72	2	2	100'	300'	50'	3	8	36
A	STORAGE** (1/500 SF)	14.4	1	2	N/A	N/A	N/A	1	8	12
B	BUSINESS (1/100 SF)	201	2	1	100'	300'	50'	6	0	101
B	STORAGE** (1/500 SF)	40.2	1	1	N/A	N/A	N/A	1	0	34
C	BUSINESS (1/100 SF)	55	2	0	100'	300'	50'	3	0	28
C	STORAGE** (1/500 SF)	11	1	0	N/A	N/A	N/A	1	0	10
A+C	BUSINESS (1/100 SF)	127	2	2	100'	300'	50'	6	8	64
B+C^	STORAGE** (1/500 SF)	51.2	1	1	N/A	N/A	N/A	1	0	44

\*ASSUMES A CODE-COMPLIANT AUTOMATIC SPRINKLER SYSTEM IS USED

\*\*ASSUMES 'LOW-HAZARD' STORAGE, AS DESCRIBED IN NFPA 101, CH. 42

\*\*\*PARKING BASED ON 1 SPACE PER 200SF FOR BUSINESS, 1 PER 600SF WAREHOUSE IN I-1 ZONING

^ASSUMES INTERIOR PARTITIONS ARE DEMOLISHED

 INDICATES NON-COMPLIANCE

NOTE: THESE CODE-RELATED FINDINGS ARE PRELIMINARY IN NATURE AND ARE TO BE USED FOR GENERAL SPACE-PLANNING PURPOSES ONLY. IN NO WAY SHOULD THIS REPORT BE USED AS A COMPLETE LIFE-SAFETY ANALYSIS.

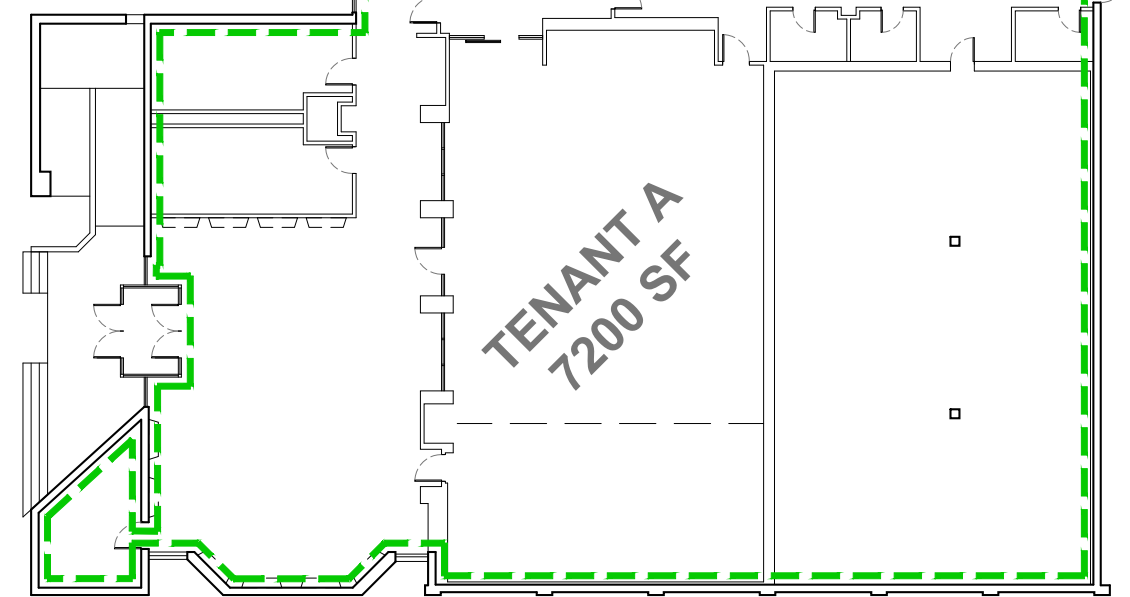

**PROJECT:** 1557 SAINT JOSEPH

**DRAWING:** CODE MATRIX DIAGRAM

**SCALE:** NOT TO SCALE

**DATE:** 2017-11-28

**POINT OFFICE**  
ARCHITECTURE & DESIGN

489 Edgewood Ave, Atlanta GA 30312  
www.point-office.com | 404.500.9913  
COPYRIGHT POINT OFFICE, LLC ALL RIGHTS RESERVED

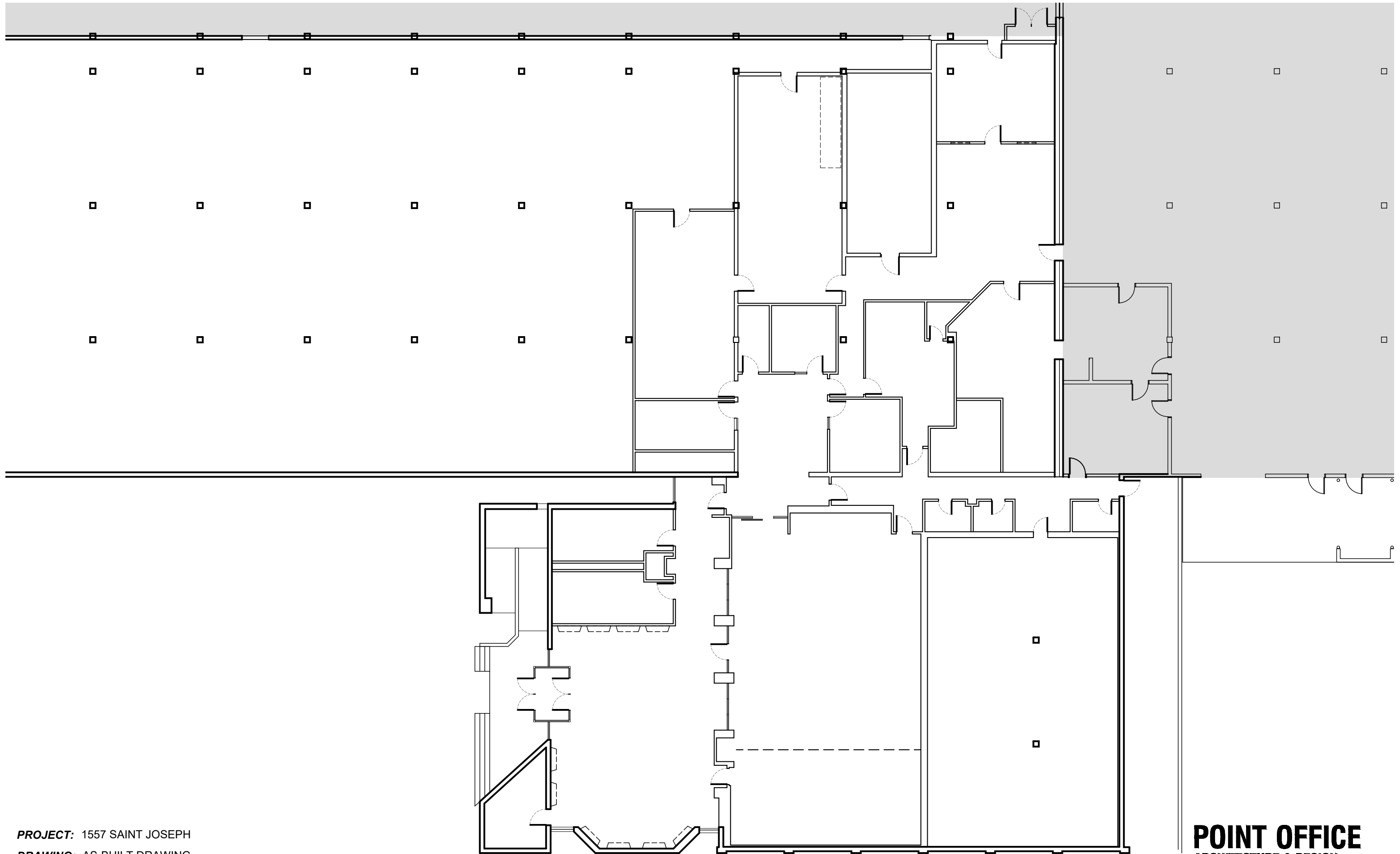

**PROJECT:** 1557 SAINT JOSEPH  
**DRAWING:** AS-BUILT DRAWING  
**SCALE:** 1/16" = 1'-0"  
**DATE:** 2017-11-28

**POINT OFFICE**  
**ARCHITECTURE & DESIGN**

489 Edgewood Ave, Atlanta GA 30312  
www.point-office.com | 404.500.9913  
COPYRIGHT POINT Office, LLC ALL RIGHTS RESERVED