



The Woodmont Company

Building solid relationships one location at a time...

# Cortana Mall BATON ROUGE, LOUISIANA



## Cortana Mall at a Glance

- » Cortana Mall is a single-level, 1,432,889 square-foot super regional shopping center located at the intersection of Airline Highway and Florida Boulevard in the heart of Baton Rouge.
- » Cortana Mall is a super regional mall well positioned to serve customers in East Baton Rouge, Livingston, Ascension, and Tangipahoa Parishes.
- » Located at the intersection of one of Baton Rouge's busiest thoroughfares of commuter traffic with 119,000 commuters a day travel the Florida Blvd./Airline Hwy. corridor.
- » Home to Virginia College, which has more than 1,200 students enrolled and taking classes daily
- » East Baton Rouge Parish has the largest population in Louisiana with 440,171 people, and the neighboring parishes of Ascension and Livingston grew at the fastest percentage rate among the state's 64 parishes over the past decade, according to the latest U.S. Census.
- » The capital region now has a population of just more than 800,000. The capital region grew by almost 14 percent over the past decade, whereas the rest of the state only grew by 1.4 percent.
- » In 2010, Baton Rouge's overall economic performance ranked in the top 20 among the country's 100 largest metro areas, according to the Brookings Institution's Metropolitan Policy Program's latest MetroMonitor report.
- » In 2010, *Bloomberg Businessweek* ranked Baton Rouge as having the 11th strongest job market in the U.S.

## ANCHOR RETAILERS

» Dillard's	» Macy's
» JCPenney	» Sears

## IN-LINE RETAILERS

» Victoria Secret's	» Bath and Body Works
» The Limited	» Aeropostale
» Footlocker	» Hot Topic
» The Children's Place	» Radio Shack
» Hibbetts Sports	» The Shoe Dept.

## AREA RETAILERS

» Bed Bath & Beyond	» Walmart Supercenter
» Lowe's	» Sam's Club
» Old Navy	» Babies R Us





The Woodmont Company

Building solid relationships one location at a time...

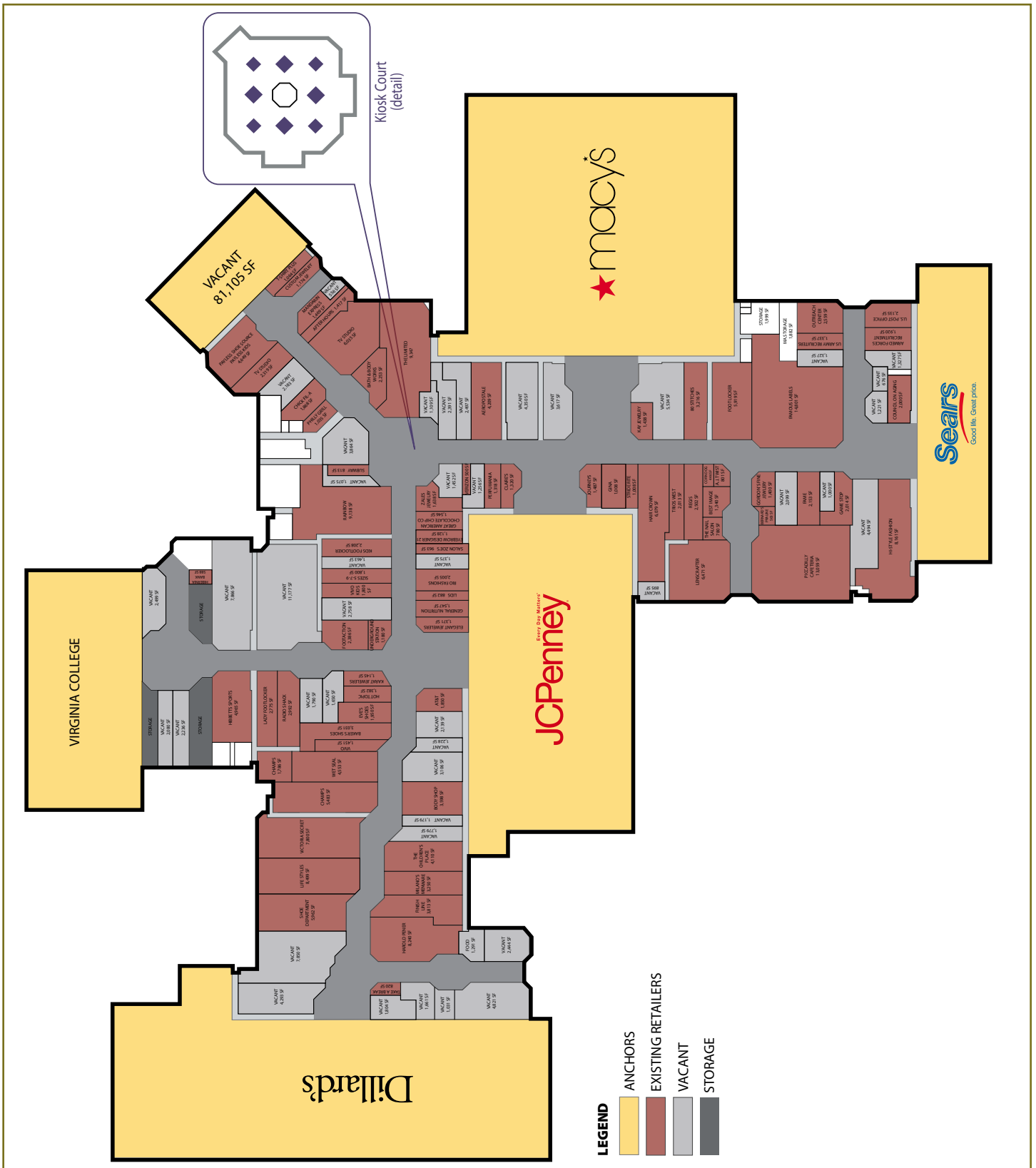



The Woodmont Company

Building solid relationships one location at a time...



PROPERTY DATA	
» Opening Date	August 6, 1976
» Site	23.08 Acres
» Parking	6,700 spaces
» Total Stores	155
» Levels	1
LEASABLE AREA	
» Total Mall GLA	1,432,889
» Retail Shops	356,945
» Anchors (Total)	1,075,944
Macy's	238,000
JCPenney	188,087
Sears	240,967
Dillard's	237,785
Virginia College	90,000
Anchor (Former Mervyn's)	81,105
DEMOGRAPHIC INFORMATION 7 Mile Radius	
» Population	311,721
» Total Households	125,741
» Avg. Household Income	\$54,595
» Median Income	\$40,557
» Median Age	33.8



**CONTACT:** Dorinda Cavender » 214.217.4606 » dcavender@woodmont.com  
 Bill Morris » 214.217.4610 » wmorris@woodmont.com

The information contained herein was obtained from sources believed reliable; However, The Woodmont Company makes no guarantees, warranties, or representations as to the completeness or accuracy therefore. The presentation of this property is subject to errors, omissions, change of price, or conditions, prior sale or lease, or withdrawal without notice.

